

Forced door lock

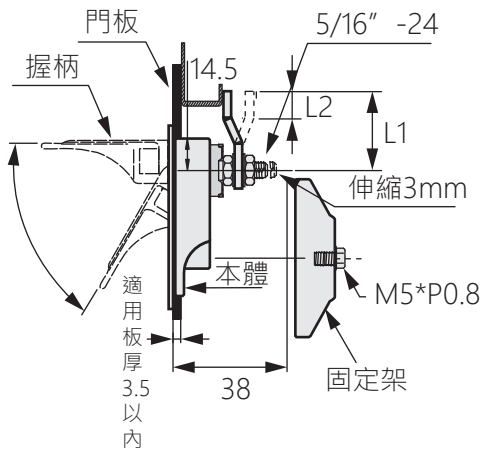

[TM-181]
[TM-182]
[TM-183]

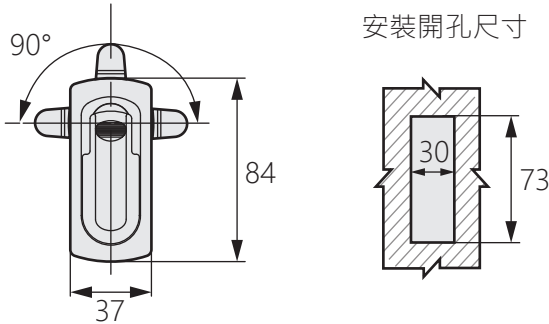

安裝示意圖

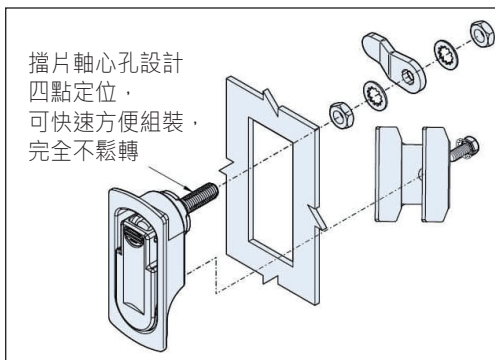

商品型號	擋片型式	安裝孔與門框建議距離(E)
TM-181	TH-14~TH-19 TH-44/TH-45	8-10
TM-182	TH-14/TH-15 TH-16	11-13
TM-183	TH-17/TH-18 TH-19	26-28

商品介紹 Product description

- 1.開啟：擋片可垂直後退3mm，使握柄迴轉順暢
- 2.關門：擋片可垂直前移3mm，使門板與箱體迫緊不鬆動
- 3.左、右、上三方向兼用型
- 4.耐熱、耐腐蝕、防塵性、防水(IP66)
- 5.另有不鏽鋼可挑選，型號：TM-1181-16B(W)(7C)

- 材質：鋅合金
- 表面處理：霧鉻、黑色、亮鉻
- 檔片選擇：TM-181: 短軸型
TM-182: 標準軸型
TM-183: 長軸型
- 軸心：鐵(L1213)/鍍鋅
擋片：鐵(SPHC)/鍍鋅

1. Opening: The baffle can be moved back 3mm vertically to make the handle rotate smoothly.
2. Closing the door: the baffle can be moved forward 3mm vertically, so that the door panel and the box body are not loosened tightly.
3. Left, right, and up three directions dual-use type
4. Heat resistance, corrosion resistance, dust resistance, waterproof (IP66)
5. Another stainless steel option is available, model: TM-1181-16B(W)(7C)

- Material: Zinc alloy
- Finish: Fog chrome, Black, Bright chrome
- File selection: TM-181: Short shaft type
TM-182: Standard shaft
TM-183: Long axle type
- Axis Material: Iron (L1213), Galvanized
Lock material: Iron (SPHC), Galvanized

商品型號			擋片型式	擋片夾持距離		L1	L2
外觀霧鉻	外觀黑色	外觀亮鉻		向內	向外		
TM-181-1-1	TM-181-2-1	TM-181-3-1	TH-14	21	31	36	12
TM-181-1-2	TM-181-2-2	TM-181-3-2	TH-17			51	27
TM-181-1-3	TM-181-2-3	TM-181-3-3	TH-15	13	39	36	12
TM-181-1-4	TM-181-2-4	TM-181-3-4	TH-18			51	27
TM-181-1-5	TM-181-2-5	TM-181-3-5	TH-16	5	47	36	12
TM-181-1-6	TM-181-2-6	TM-181-3-6	TH-19			51	27
TM-182-1-1	TM-182-2-1	TM-182-3-1	TH-14	27-37	37-47	36	12
TM-182-1-2	TM-182-2-2	TM-182-3-2	TH-17			51	27
TM-182-1-3	TM-182-2-3	TM-182-3-3	TH-15	19-29	45-55	36	12
TM-182-1-4	TM-182-2-4	TM-182-3-4	TH-18			51	27
TM-182-1-5	TM-182-2-5	TM-182-3-5	TH-16	11-21	53-63	36	12
TM-182-1-6	TM-182-2-6	TM-182-3-6	TH-19			51	27
TM-183-1-1	TM-183-2-1	TM-183-3-1	TH-14	44-54	54-64	36	12
TM-183-1-2	TM-183-2-2	TM-183-3-2	TH-17			51	27
TM-183-1-3	TM-183-2-3	TM-183-3-3	TH-15	36-46	62-72	36	12
TM-183-1-4	TM-183-2-4	TM-183-3-4	TH-18			51	27
TM-183-1-5	TM-183-2-5	TM-183-3-5	TH-16	28-38	70-80	36	12
TM-183-1-6	TM-183-2-6	TM-183-3-6	TH-19			51	27

[TH-14] [TH-15] [TH-16]

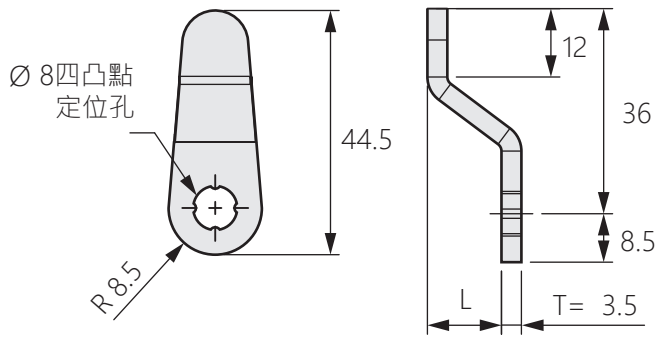

商品型號	L
鐵	
TH-14	5
TH-15	13
TH-16	21

[TH-17]

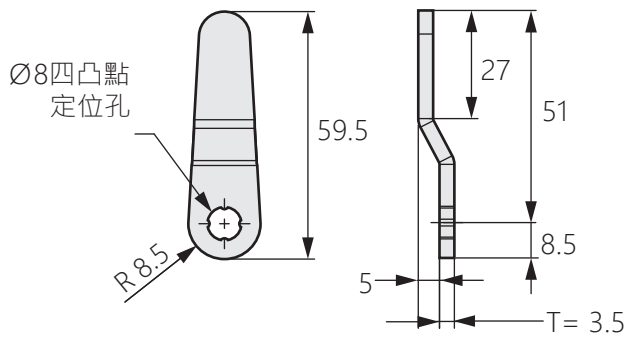

[TH-44]

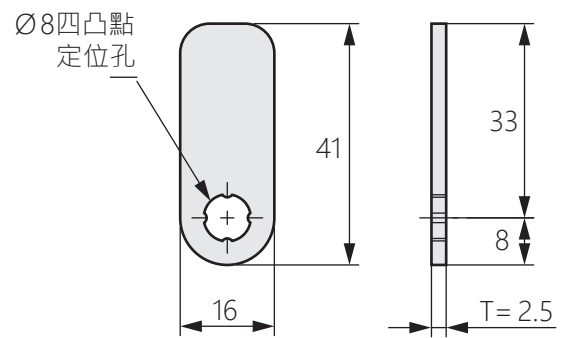

[TH-18]

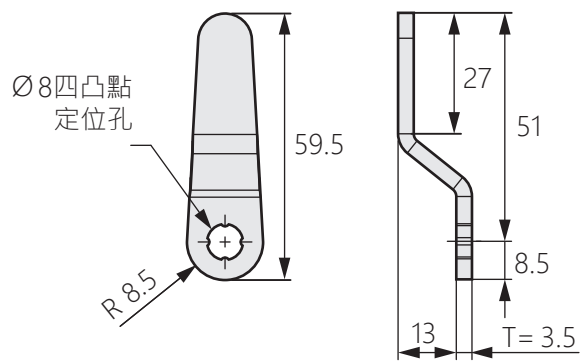

[TH-45]

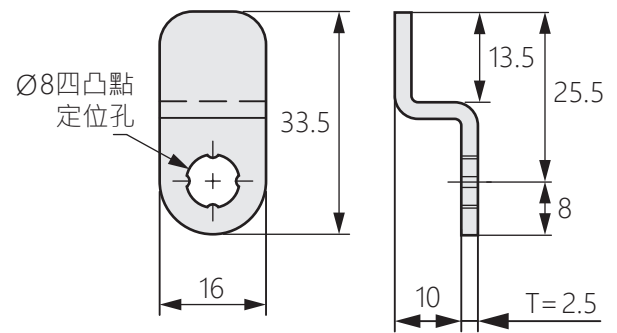

[TH-19]

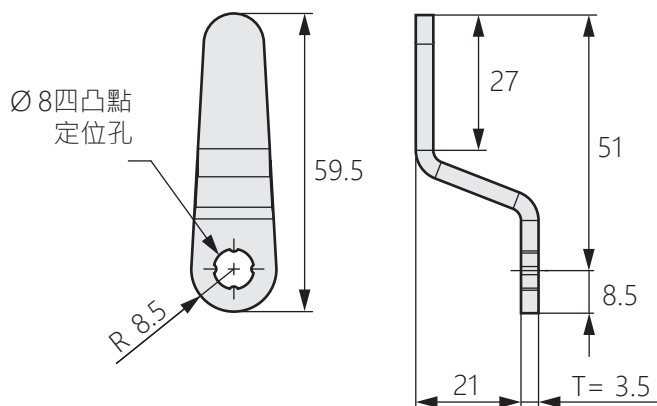

[TM-1181-16B(W)(7C)] 使用

