

# 圓頭鎖

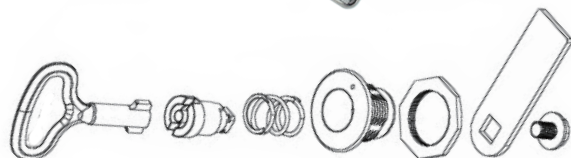

TM-092

Cam lock



## 商品介紹 Product description

內部為彈簧裝置，即使有震動也不影響鎖的功能。

- 材質：鋅合金、擋片(冷軋鋼板)
- 表面處理：鍍沙鉻
- 用途：機櫃、控制箱等
- 備註：可選用不同鎖片。

Innerspring structure and without impact even vibration

- Material: Zinc alloy
- Finish: Bright chrome plating
- Uses: Cabinets, Control box, etc.
- Notes: Straight and triangular lock cylinder stainless steel products are customized.

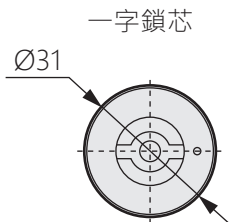
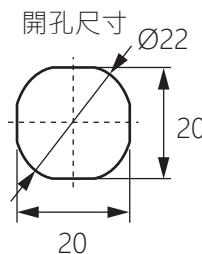
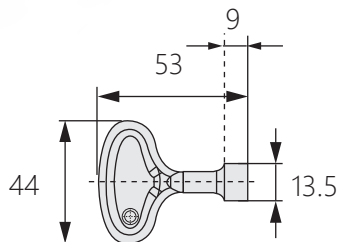
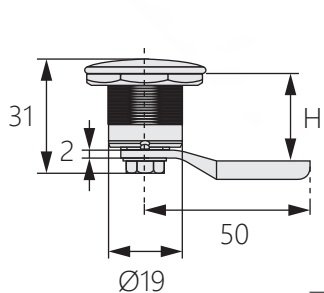

鎖片型號	止口高度H
TH-088	18
TH-488	22
TH-788	25
TH-1488	32