

# 輕巧圓頭門鎖



TM-003

Light round head lock

商品介紹 Product description

外觀小巧、美觀，左右兼用型，可選用通開和不通開的鑰匙鎖芯。



[ TM-003-1 ]



[ TM-003-2 ]

- 材質：鋅合金(ZDC)、冷軋板
- 用途：小型機箱、機櫃、配電箱

The appearance is small and beautiful, and it can be used for both left and right. You can choose to open or not open Key lock cylinder.

- Material: Zinc Alloy (ZDC), cold rolled sheet
- Uses: Small chassis, cabinet, distribution box.

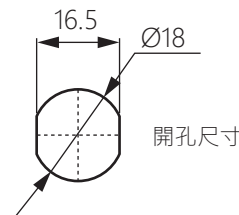
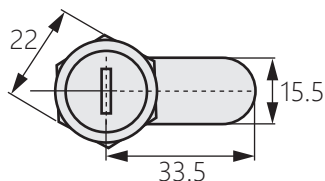
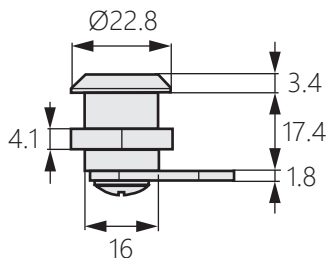

[ TM-003-1 ]

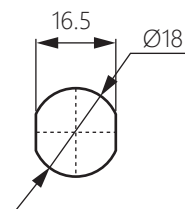
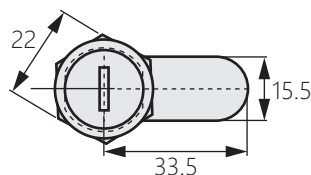
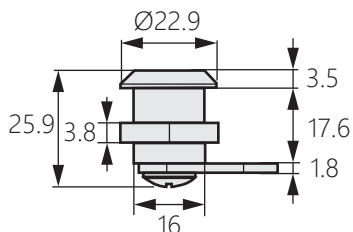

[ TM-003-2 ]

商品型號	形式
TM-003-1	不通開
TM-003-2	通開