

# 嵌入式把手

Embedded pulls



TG-028



商品介紹 Product description

適用各種產業機檯或箱體、門板供手拉抬使用。

- 材質：不鏽鋼SUS304
- 表面處理：拉絲加工
- 用途：無塵室

It is suitable for all kinds of industrial machines or cabinets and door panels for manual lifting.

- Material: Stainless steel 304
- Finish: Wire drawing
- Uses: Clean room

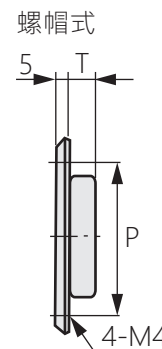
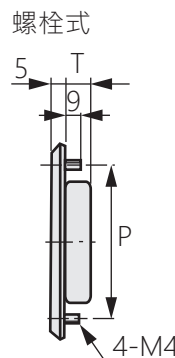
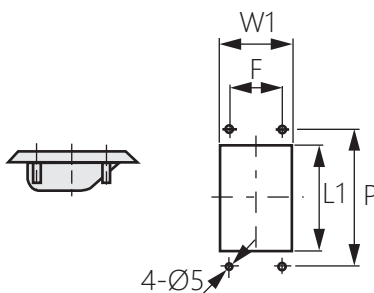
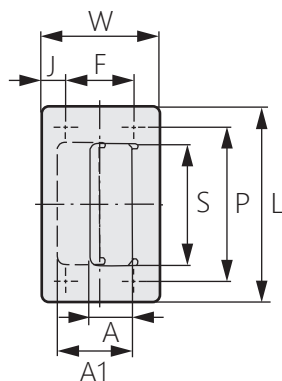

商品型號		L	W	P	F	S	A	A1	T	(J)	L1	W1
螺栓式	螺帽式											
TG-028-1-A	TG-028-1-B	138	88	110	65	96	35	62	21	11.5	99	64
TG-028-2-A	TG-028-2-B	109.5	64	88	38	67.5	25	40	14.5	13	73	42
TG-028-3-A	TG-028-3-B	94	60	76	32	61	25	43	12	14.5	63	45