

# 滾輪型球頭柱塞



## LZ-106

Roller ball plunger

商品介紹 Product description

- 1.球頭柱塞結構簡單，先端球頭依靠內部彈簧頂出固定的行程，克服彈力壓入球頭即可釋放。
- 2.前端無扳手槽，須配合內六角扳手使用。

- 1.The ball head plunger has a simple structure,the tip ball head relies on the internal spring to push out a fixed stroke,and the ball head can be released by overcoming the elastic force.
- 2.There is no wrench slot at the front end and must be used with an Allen wrench.

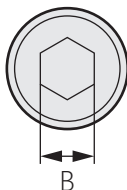
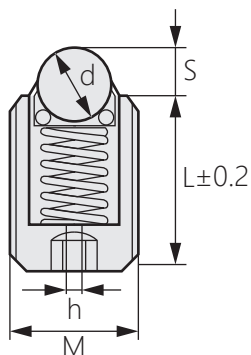

商品型號		M	d	S	L	B	h	彈力	
								超輕載 (1H)	
								min	max
LZ-106-1-1	LZ-106-2-1	6	3	0.8	13	3	1.5	8.1	29.6
LZ-106-1-2	LZ-106-2-2	8	4	1.3	15	4	2	12.1	39.8
LZ-106-1-3	LZ-106-2-3	10	5	1.6	16	5	2.5	13.5	44.4
LZ-106-1-4	LZ-106-2-4	12	7.1	2.3	20	6	3	16.1	46.9
LZ-106-1-5	LZ-106-2-5	16	9.5	3.1	25	8	4	26.1	88.2

商品型號	主體		球頭		副球		彈簧	使用溫度範圍
	材質	材質	硬度	材質	硬度	材質		
LZ-106-1	SCM304	SUS440C	55HRC	SUS440C	55HRC	SUS631J1	-30° C-100° C	
LZ-106-2		聚縮醛	-				-30° C-80° C	