

一字頭球頭柱塞

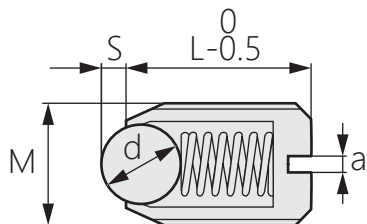

LZ-103

Slotted ball plunger



商品介紹 Product description

球頭柱塞結構簡單，先端球頭依靠內部彈簧頂出固定的行程，克服彈力壓入球頭即可釋放。

The ball head plunger has a simple structure, the tip ball head relies on the internal spring to push out a fixed stroke, and the ball head can be released by overcoming the elastic force.

商品型號	主體			球頭		彈簧
	材質	硬度	表面處理	材質	硬度	材質
LZ-103-1	SMC435	29-35HRC	黑色	SUJ2	55HRC	SWP-B
LZ-103-2				聚縮醛		
LZ-103-3	SUS304	-	-	SUS440C	55HRC	
LZ-103-4				聚縮醛		

商品型號				M	L	d	S	a	彈力	
									min	max
LZ-103-1-1	LZ-103-2-1	LZ-103-3-1	LZ-103-4-1	3	6.8.10.12	1.5	0.5	1	1.5	2.9
LZ-103-1-2	LZ-103-2-2	LZ-103-3-2	LZ-103-4-2	4	6.10.12.16	2	0.7	1	3.9	9.8
LZ-103-1-3	LZ-103-2-3	LZ-103-3-3	LZ-103-4-3	5	10.12.16.20	2.5	0.8	1.2	4.9	19.6
LZ-103-1-4	LZ-103-2-4	LZ-103-3-4	LZ-103-4-4	6	10.12.14.16.20	3	1.2	1.2	4.9	29.4
LZ-103-1-5	LZ-103-2-5	LZ-103-3-5	LZ-103-4-5	8	10.12.16.20.25	5	2	1.5	12.7	39.2
LZ-103-1-6	LZ-103-2-6	LZ-103-3-6	LZ-103-4-6	10	16.19.20.25.30	6	2.5	1.5	18.6	49
LZ-103-1-7	LZ-103-2-7	LZ-103-3-7	LZ-103-4-7	12	20.22.25.30	8	3	2	19.6	58.8
LZ-103-1-8	LZ-103-2-8	LZ-103-3-8	LZ-103-4-8	16	24.30	10	4	2	29.4	98
LZ-103-1-9	LZ-103-2-9	LZ-103-3-9	LZ-103-4-9	20	30	13	5	3	35	120
LZ-103-1-10	LZ-103-2-10	LZ-103-3-10	LZ-103-4-10	24	35	16	7	3	50	200