

商品介紹 Product description

- 材質：主體-碳鋼、配件-鐵
- 表面處理：黑色塗裝
- 用途：板金工業、用於支撐門板、氣窗設備等
- 備註：1.另有不鏽鋼產品可選購。  
2.訂購時請主動告知氮氣填充量。  
3.有效行程至少需預留5-10mm以防碰撞。

- Material: Main body - carbon steel  
Accessories - iron
- Finish: Black painting
- Uses: Sheet metal industry, used to support door panels, transom equipment, etc.
- Notes:
  1. Another stainless steel product is available for purchase.
  2. Please take the initiative to inform the nitrogen filling amount when ordering.
  3. At least 5-10mm of effective travel should be reserved to prevent collision.

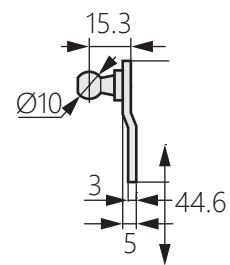
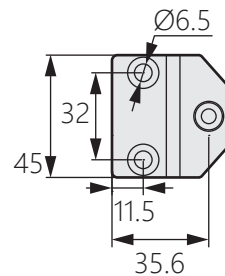
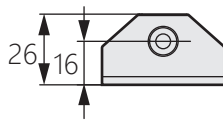
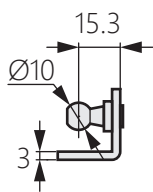
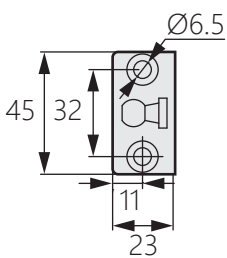
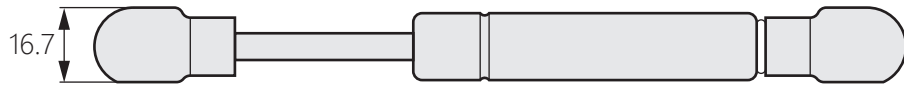
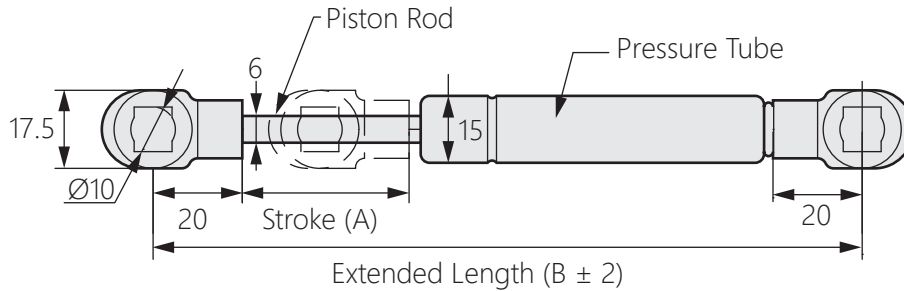

[TH-11-1-2]

[TH-11-2-2]

商品型號	行程 (A)	總長 (B)	氮氣值 (N)
HG-182-1	40	159	50-300N
HG-182-2	60	199	
HG-182-3	80	240	
HG-182-4	90	255	
HG-182-5	100	280	
HG-182-6	120	321	
HG-182-7	150	380	

備註：9.8 牛頓 (N)=1 公斤 (KG)=2.2 磅 (LBS)