

隱藏式門扣

Hidden door buckle

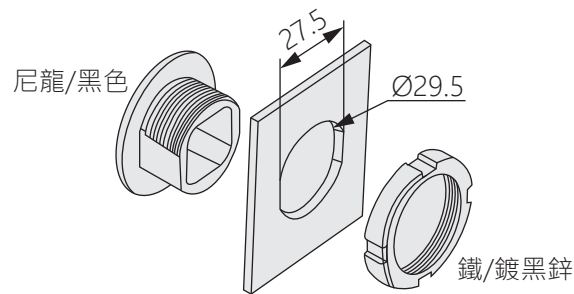

HS-P-4

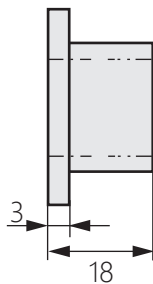
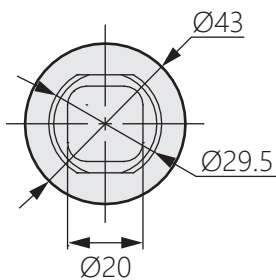

商品介紹 Product description

- 1.門內安裝，迫緊部份不暴露在門外。
- 2.安裝在門側邊有箱體的門框上，即平門安裝。
- 3.可搭配TM-80.TM-90使用。

- 材質：鐵、塑膠
- 表面處理：鍍黑鋅。
- 用途：烤箱設備、試驗箱等

1. Installed in the door, the pressing part is not exposed outside the door.
2. Install it on the door frame with a box on the side of the door, that is, flat door installation.
3. Can be used with TM-80.TM-90.

- Material: Iron,plastic
- Finish: Black zinc plated
- Uses: Oven equipment,test chambers,etc.