

門扣快速夾鉗



DK-151

Double row magnetic

商品介紹 Product description

[DK-151-1-1]
[DK-151-2-1]

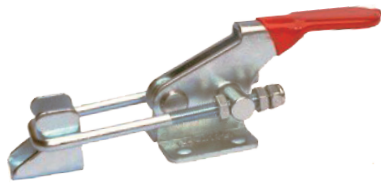

[DK-151-1-2]
[DK-151-2-2]



[DK-151-1-4]
[DK-151-2-4]



- 1.可調節型全金屬夾鉗，適用於工作負載大以需要大幅度調整間距的情況。
- 2.體積小，安裝方便。

- 材質：不鏽鋼SUS304、鐵
- 表面處理：鐵-電鍍白鋅
- 用途：電箱電櫃、機械設備等

1. Adjustable row all-metal clamps, suitable for situations where the working load is large and the spacing needs to be greatly adjusted.
2. Small size, easy to install.

- Material: Stainless steel SUS304, iron
- Finish: Iron-electroplated white zinc
- Uses: Electric box, electrical cabinet, mechanical equipment, etc.

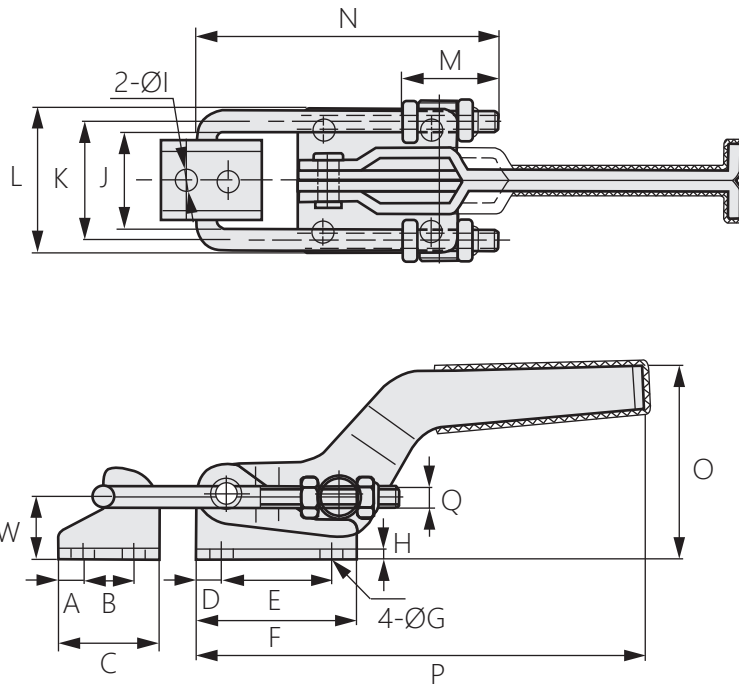

商品型號		A	B	C	D	E	F	G	H	I	J	K	L	M
不鏽鋼	鐵													
DK-151-1-1	DK-151-2-1	5	10	20	5.2	15.9	26.2	4.4	2	4.4	19	19	28.2	24
DK-151-1-2	DK-151-2-2	6.8	12	25.4	6.4	19	39.7	6.7	3	6	31.6	27	44.4	38
DK-151-1-4	DK-151-2-4	9.5	19.2	38.1	9.5	41.3	60.3	8.6	4	8.5	38.1	44.5	54	52

商品型號		N	O	P	Q	W	拉力 (KG)
不鏽鋼	鐵						
DK-151-1-1	DK-151-2-1	58-85	29.3	75	M4P=0.7	12	163
DK-151-1-2	DK-151-2-2	90-260	41.3	123.7	M5P=1	12.2	318
DK-151-1-4	DK-151-2-4	115-450	74	168.5	M8P=1.25	23.2	900